

NOTES:

1. REFER TO THE GENFLEX™ WEBSITE FOR MOST CURRENT INFORMATION.
2. REFER TO EZT-LS-01 OR EZT-LS-02 FOR WELD WIDTH.
3. INSTALL METAL WORK TO SMACNA RECOMMENDATIONS.

STEP #3

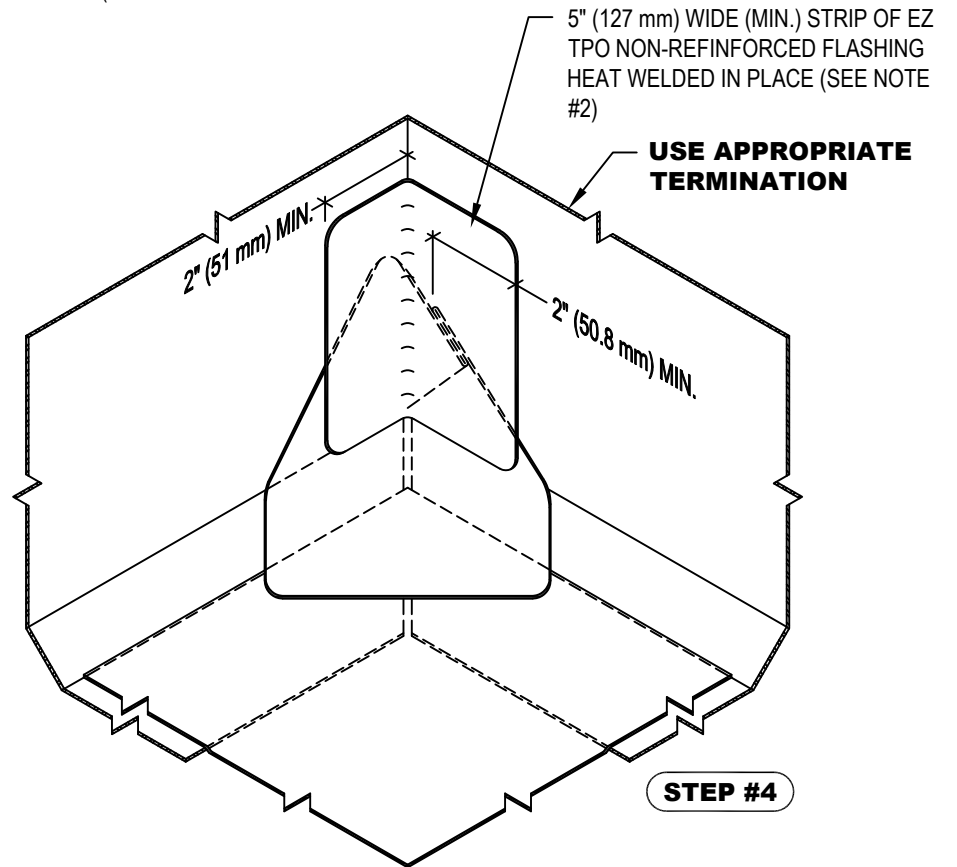
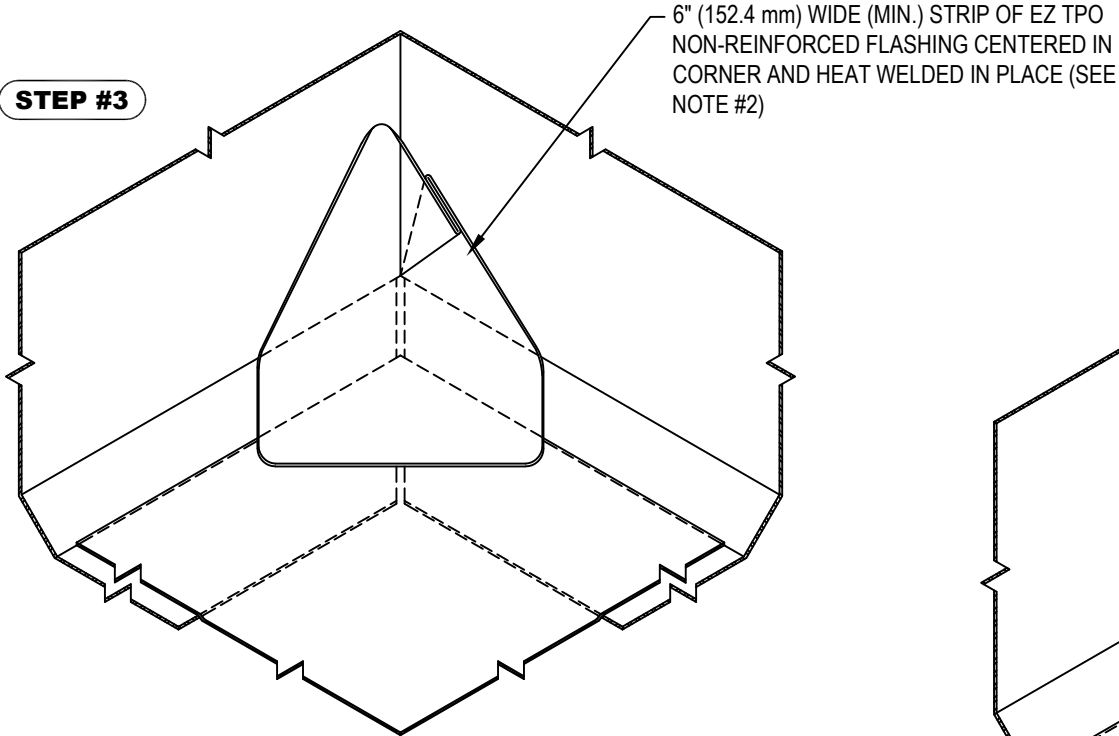

STEP #4

WARRANTY MEMBRANE REQUIREMENTS:

15-YEAR
TPO - 45 MIL

20-YEAR
TPO - 60 MIL

**INSIDE CORNER WITH TPO COATED METAL (WITH BRAKE)
INSTALLATION STEPS 3 & 4**

MATERIAL: EZ TPO

ACCEPTABLE SYSTEMS: ALL

MAXIMUM WARRANTY: 20 Years

ISSUE / REVISION
DATE:

04/16/2026

DETAIL NO.

EZT-C-08B

NOT TO SCALE

GENFLEX: (800) 443-4272 www.genflex.com

