

NOTE:

1. REFER TO THE GENFLEX™ WEBSITE FOR MOST CURRENT INFORMATION.
2. COMPRESSIBLE TUBE (SUPPLIED BY OTHERS) DIAMETER MUST EXCEED THE DECK OPENING BY 50% MIN. OR DESIGNED MOVEMENT (WHICHEVER IS GREATER).
3. APPROPRIATE MEMBRANE ADHESIVE REQUIRED BETWEEN MEMBRANE AND INSULATION FOR ADHERED SYSTEMS.
4. MAXIMUM 10" (254 mm) LONG FASTENERS. (NOTE: WOOD BLOCKING MAY BE SUBSTITUTED FOR INSULATION TO REDUCE FASTENER LENGTH REQUIREMENTS.
5. REFER TO EZT-LS-15 FOR ADDITIONAL LAP SPLICE REQUIREMENTS.

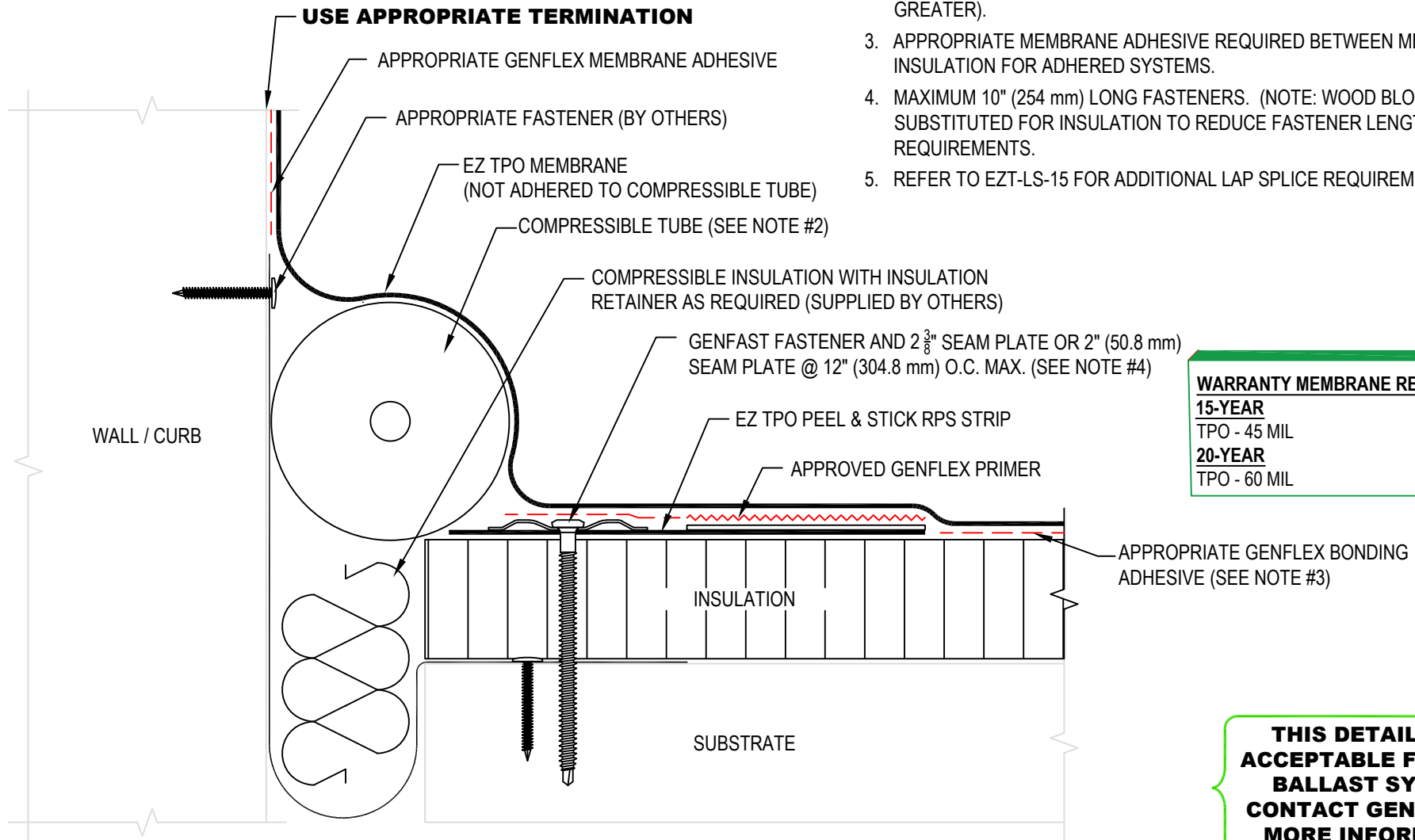

WARRANTY MEMBRANE REQUIREMENTS:
15-YEAR
 TPO - 45 MIL
20-YEAR
 TPO - 60 MIL

THIS DETAIL IS NOT ACCEPTABLE FOR PAVER BALLAST SYSTEMS. CONTACT GENFLEX FOR MORE INFORMATION.



EXPANSION JOINT (FIELD FABRICATED) WITH EZ TPO PEEL & STICK RPS - ROOF TO WALL

MATERIAL: EZ TPO

ACCEPTABLE SYSTEMS: ALL

GENFLEX: (800) 443-4272 www.genflex.com

MAXIMUM WARRANTY: 20 Years

ISSUE / REVISION DATE:

04/20/2026

NOT TO SCALE

DETAIL NO.

EZT-E-01