

**NOTE:**

1. REFER TO THE GENFLEX™ WEBSITE FOR MOST CURRENT INFORMATION.
2. COMPRESSIBLE TUBE (SUPPLIED BY OTHERS) DIAMETER MUST EXCEED THE DECK OPENING BY 50% MIN. OR DESIGNED MOVEMENT (WHICHEVER IS GREATER).
3. APPROPRIATE MEMBRANE ADHESIVE REQUIRED BETWEEN MEMBRANE AND INSULATION FOR ADHERED SYSTEMS.
4. MAXIMUM 10" (254 mm) LONG FASTENERS.  
(NOTE: WOOD BLOCKING MAY BE SUBSTITUTED FOR INSULATION TO REDUCE FASTENER LENGTH REQUIREMENTS.)
5. REFER TO EZT-LS-15 FOR ADDITIONAL LAP SPLICE REQUIREMENTS.

**WARRANTY MEMBRANE REQUIREMENTS:**

**15-YEAR**

TPO - 45 MIL

**20-YEAR**

TPO - 60 MIL

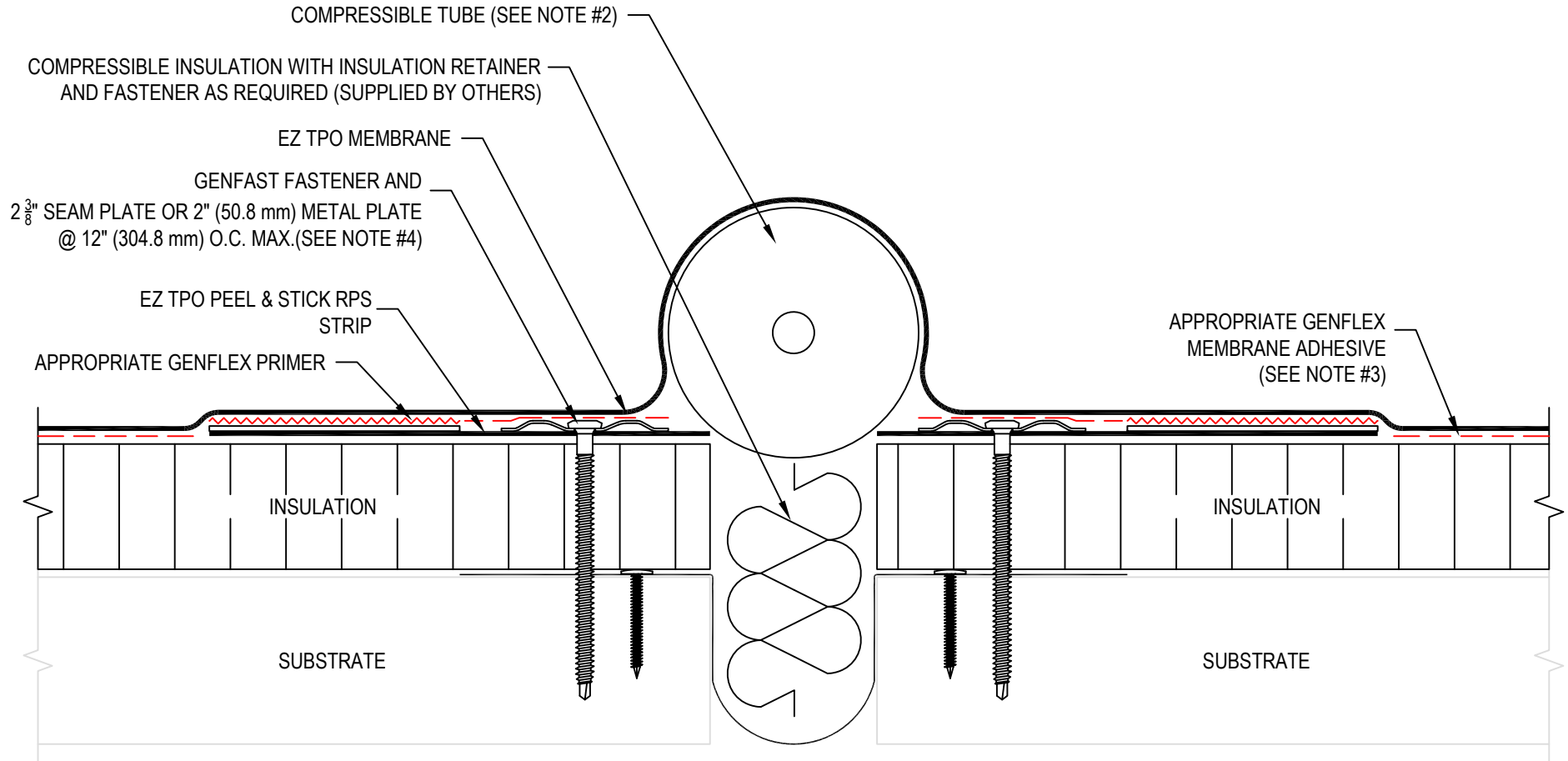

**EXPANSION JOINT (FIELD FABRICATED)  
WITH EZ TPO P&S RPS - ROOF TO ROOF**

MATERIAL: EZ TPO

ACCEPTABLE SYSTEMS: ALL

MAXIMUM WARRANTY: 20 Years

ISSUE / REVISION  
DATE:

04/20/2026

DETAIL NO.

**EZT-E-05**

NOT TO SCALE

GENFLEX: (800) 443-4272 www.genflex.com