

USE APPROPRIATE TERMINATION

NOTE:

1. REFER TO THE GENFLEX™ WEBSITE FOR MOST CURRENT INFORMATION.
2. REFER TO DETAIL EZ-LS-01 OR EZT-LS-02 FOR WELD WIDTH.
3. STONE BALLAST SHOWN - BALLAST PAVERS ACCEPTABLE IN PLACE OF BALLAST WHEN APPROVED BY GENFLEX. REFER TO JOB SPECIFICATIONS.
4. WHEN REINFORCEMENT OF TPO MEMBRANE IS EXPOSED, REFER TO EZT-LS-14 FOR CUT EDGE SEALANT APPLICATION.

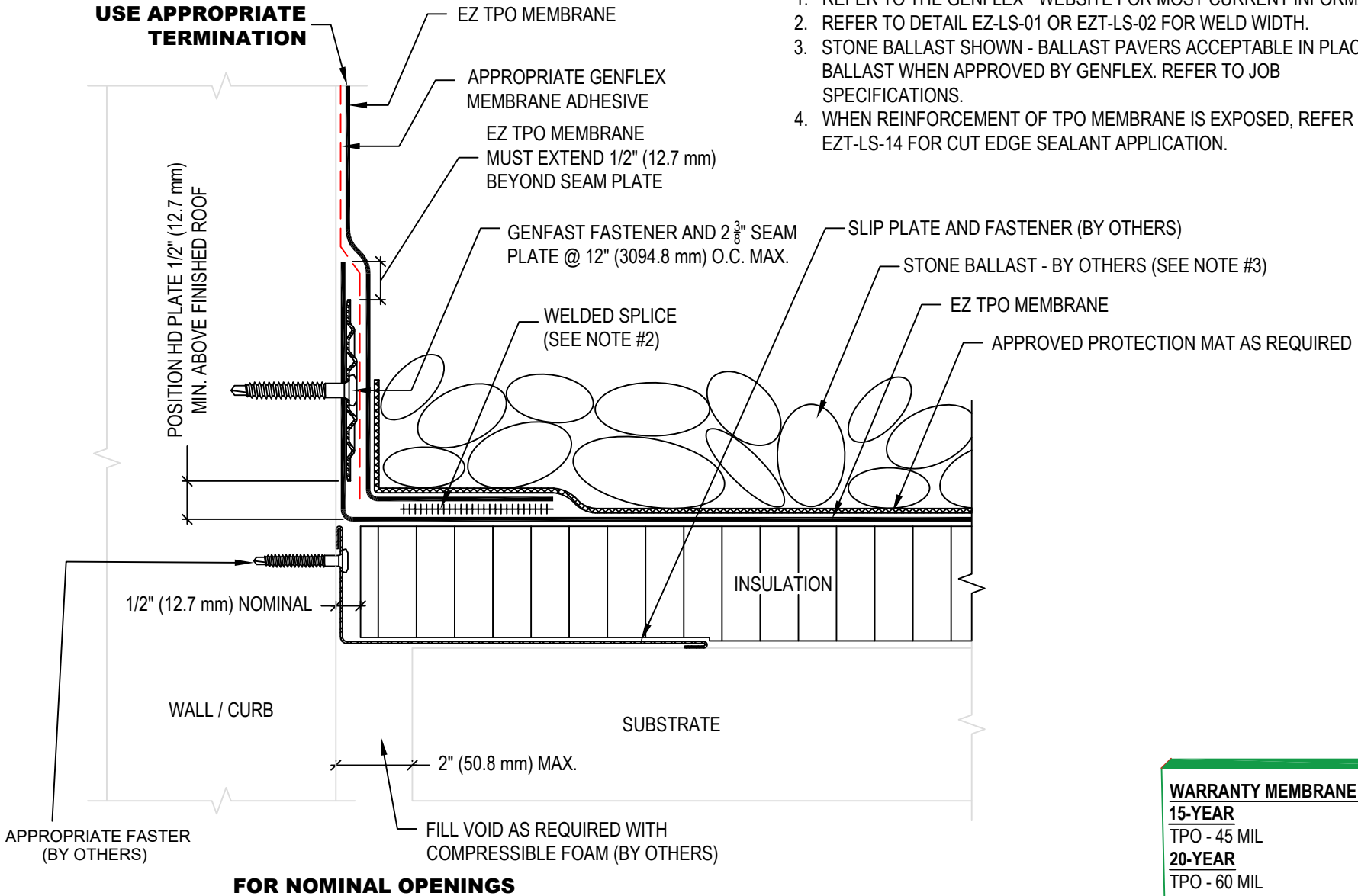

WARRANTY MEMBRANE REQUIREMENTS:
15-YEAR
 TPO - 45 MIL
20-YEAR
 TPO - 60 MIL

FOR NOMINAL OPENINGS



EXPANSION JOINT WITH SLIP PLATE - ROOF TO WALL

MATERIAL: EZ TPO

ACCEPTABLE SYSTEMS: ALL

MAXIMUM WARRANTY: 20 Years

ISSUE / REVISION DATE:

04/20/2026

DETAIL NO.

EZT-E-11

NOT TO SCALE

GENFLEX: (800) 443-4272 www.genflex.com