

WARRANTY MEMBRANE REQUIREMENTS:

15-YEAR

TPO - 45 MIL

20-YEAR

TPO - 60 MIL

NOTE:

1. REFER TO THE GENFLEX™ WEBSITE FOR MOST CURRENT INFORMATION.
2. GROUND WIRE SUPPORTS SHALL BE INSTALLED IN A SIMILAR MANNER TO LIGHTNING RODS.
3. A SUFFICIENT NUMBER OF GROUND WIRE SUPPORTS MUST BE INSTALLED TO THAT THE GROUND WIRE DOES NOT COME IN CONTACT WITH FIELD OR FLASHING MEMBRANE

4. IF GROUND WIRE COMES IN CONTACT WITH FIELD OR FLASHING MEMBRANE, INSTALL TPO PEEL & STICK FLASHING OR SACRIFICIAL LAYER OF APPROPRIATE TPO MEMBRANE UNDER THE GROUND WIRE TO PREVENT CONTACT WITH THE ROOFING MEMBRANE.
5. MECHANICALLY FASTENED MEMBRANE SYSTEMS REQUIRE THE GROUND WIRE TO BE PLACED PARALLEL TO AND WITHIN 8" (203.2 mm) OF THE MECHANICAL ATTACHMENT. ADDITIONAL MECHANICAL ATTACHMENT IS REQUIRED UNDER GROUND WIRE AT ANY AREAS WHERE THE GROUND WIRE FALLS BETWEEN OR PERPENDICULAR TO MECHANICAL ATTACHMENT.
6. GENFLEX ASSUMES NO RESPONSIBILITY FOR ATTACHMENT OF LIGHTNING RODS OR DAMAGE TO THE ROOF SYSTEM DUE TO FAILURE OR DETACHMENT.

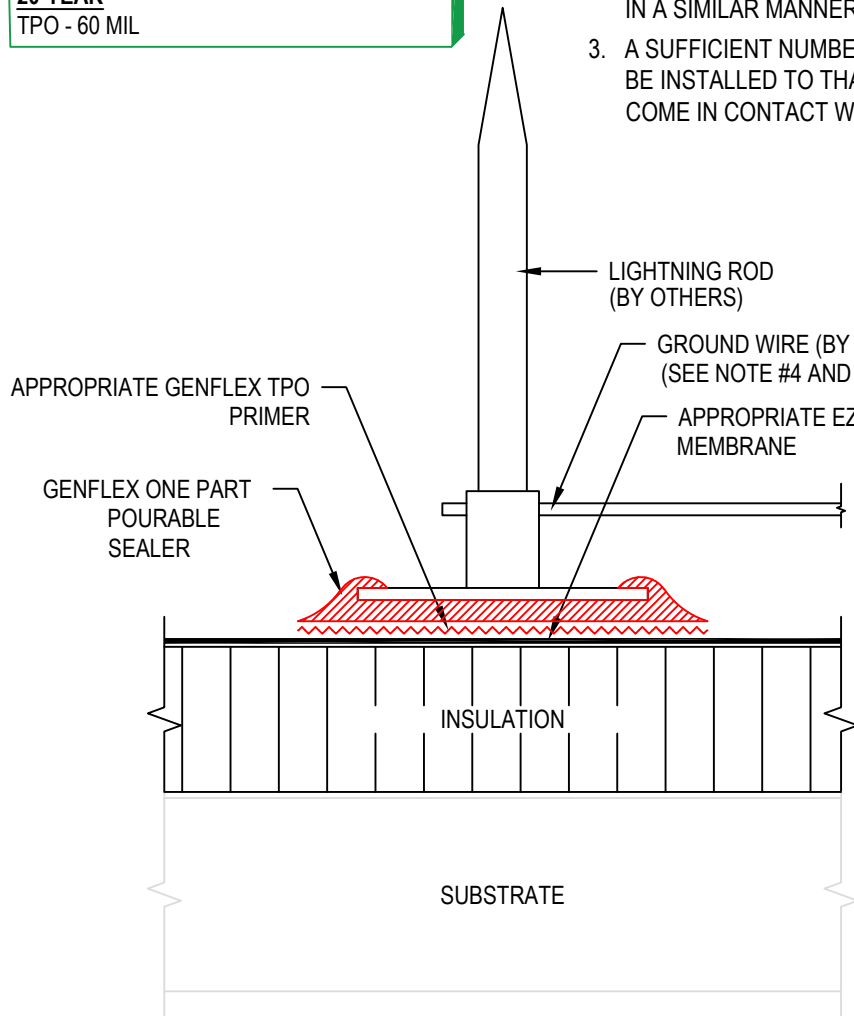

ROOF MOUNT

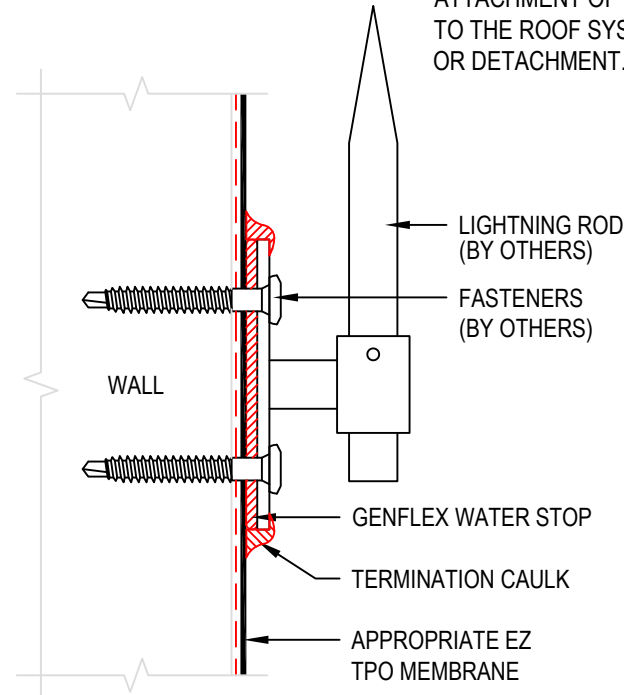

WALL MOUNT



LIGHTNING ROD

MATERIAL: EZ TPO

ACCEPTABLE SYSTEMS: ALL

MAXIMUM WARRANTY: 20 Years

ISSUE / REVISION DATE:

04/20/2026

DETAIL NO.

EZT-M-06

NOT TO SCALE