

USE APPROPRIATE TERMINATION

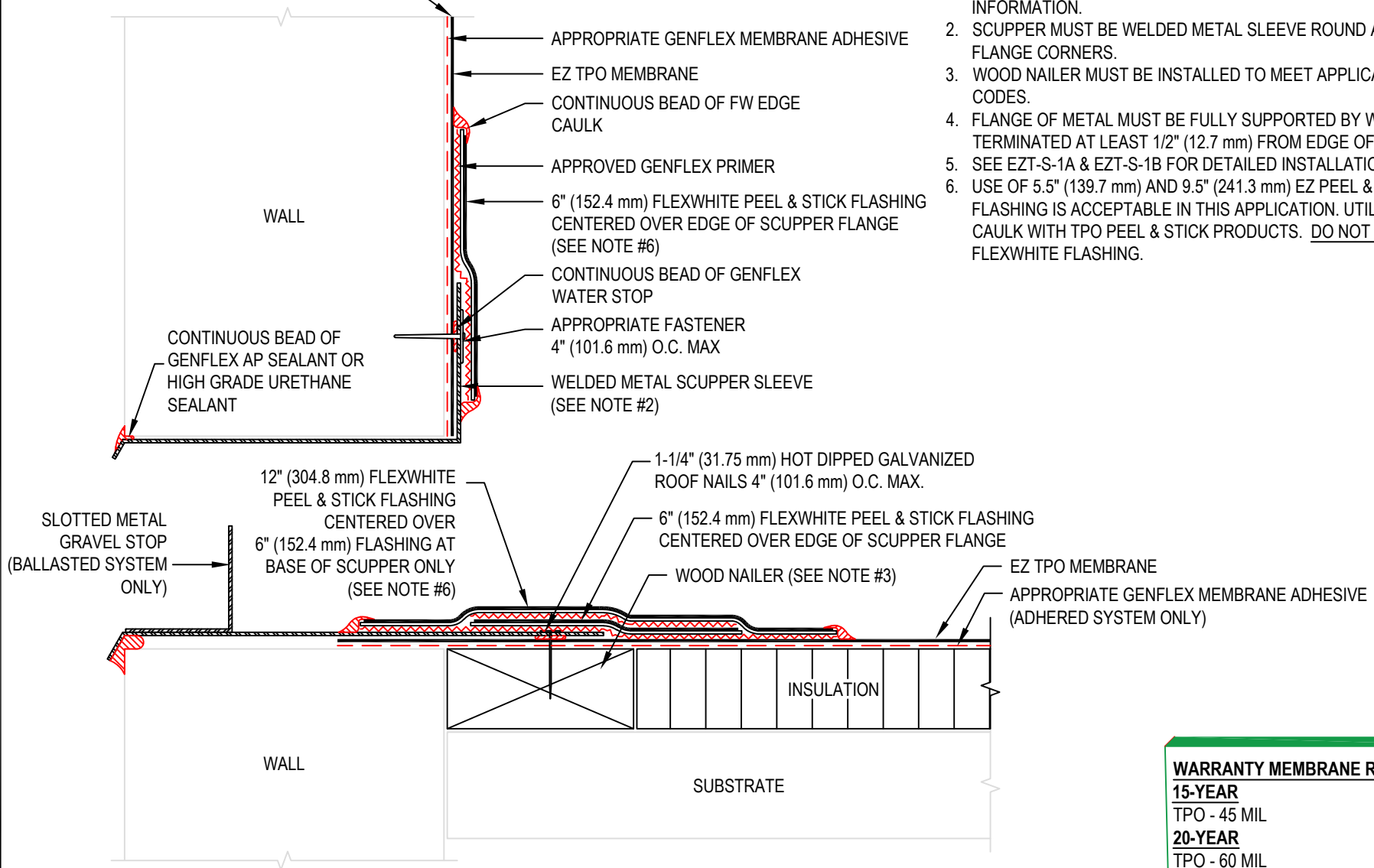

NOTE:

1. REFER TO THE GENFLEX™ WEBSITE FOR THE MOST CURRENT INFORMATION.
2. SCUPPER MUST BE WELDED METAL SLEEVE ROUND ALL SHEET METAL FLANGE CORNERS.
3. WOOD NAILER MUST BE INSTALLED TO MEET APPLICABLE BUILDING CODES.
4. FLANGE OF METAL MUST BE FULLY SUPPORTED BY WOOD AND TERMINATED AT LEAST 1/2" (12.7 mm) FROM EDGE OF WOOD.
5. SEE EZT-S-1A & EZT-S-1B FOR DETAILED INSTALLATION INSTRUCTIONS.
6. USE OF 5.5" (139.7 mm) AND 9.5" (241.3 mm) EZ PEEL & STICK TPO FLASHING IS ACCEPTABLE IN THIS APPLICATION. UTILIZE EZ TPO EDGE CAULK WITH TPO PEEL & STICK PRODUCTS. DO NOT MIX WITH FLEXWHITE FLASHING.

WARRANTY MEMBRANE REQUIREMENTS:
15-YEAR
TPO - 45 MIL
20-YEAR
TPO - 60 MIL



THRU-WALL SCUPPER (WELDED SLEEVE)

MATERIAL: EZ TPO

ACCEPTABLE SYSTEMS: ALL

MAXIMUM WARRANTY: 20 Years

ISSUE / REVISION DATE:

04/20/2026

NOT TO SCALE

DETAIL NO.

EZT-S-01