

USE APPROPRIATE TERMINATION

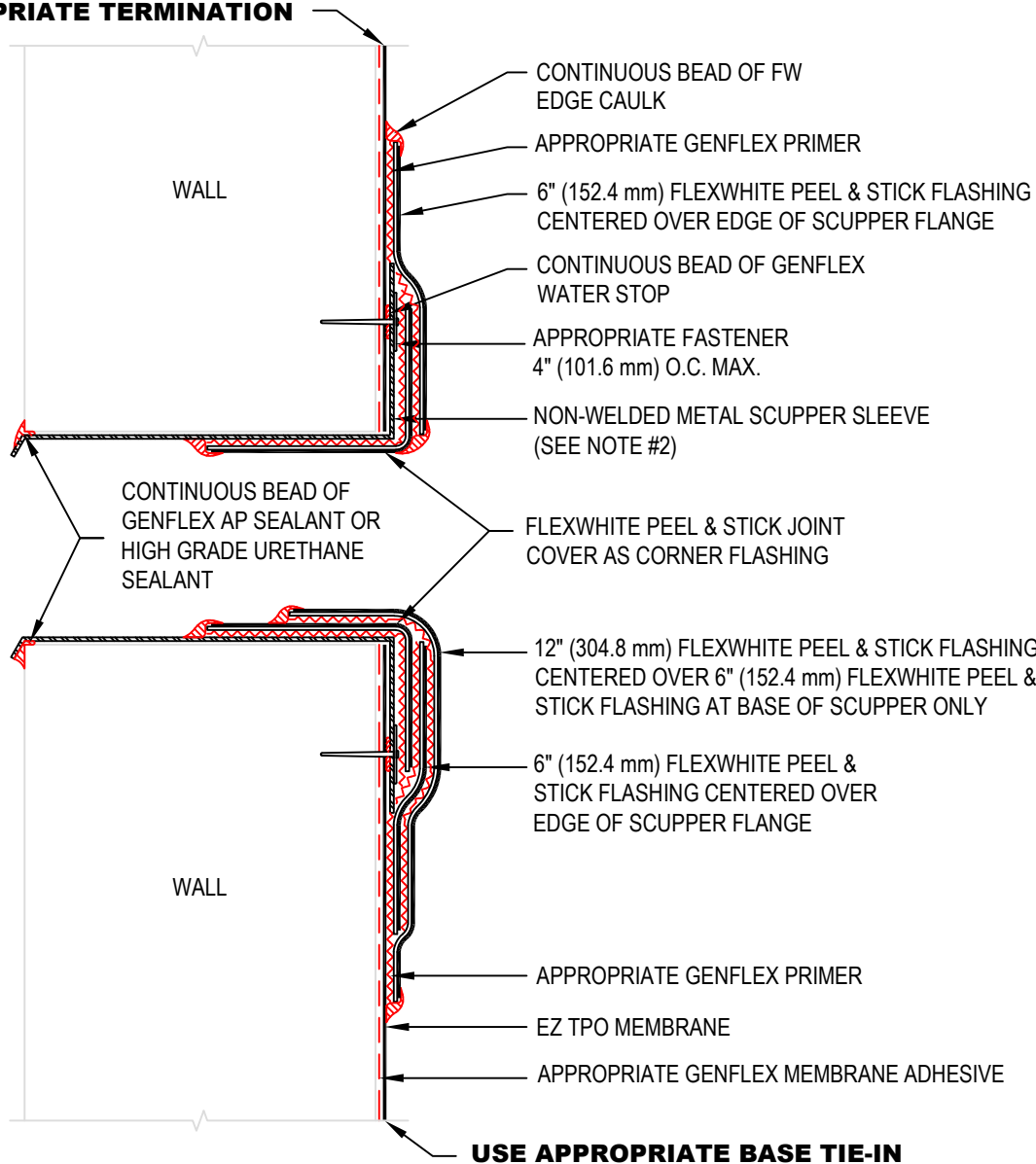

NOTE:

1. REFER TO THE GENFLEX™ WEBSITE FOR THE MOST CURRENT INFORMATION.
2. ROUND ALL SHEET METAL FLANGE CORNERS.
3. SEE EZT-S-04A, EZT-S-04B & EZT-S-04C FOR DETAILED INSTALLATION INSTRUCTIONS.

WARRANTY MEMBRANE REQUIREMENTS:
15-YEAR
 TPO - 45 MIL
20-YEAR
 TPO - 60 MIL



OVERFLOW THRU-WALL SCUPPER (NON-WELDED SLEEVE)

MATERIAL: EZ TPO

ACCEPTABLE SYSTEMS: ALL

GENFLEX: (800) 443-4272 www.genflex.com

MAXIMUM WARRANTY: 20 Years

ISSUE / REVISION DATE:
 04/20/2026

DETAIL NO.
EZT-S-04

NOT TO SCALE