

### CANTED METAL EDGE

(H)	(X)	NAILER COVERAGE
5"	3"	1
6 1/2"	4 1/2"	2
8"	6"	3
9 1/2"	7 1/2"	4
11"	9"	5
1'-0 1/2"	10 1/2"	6

**NOTE:**

1. REFER TO THE GENFLEX™ WEBSITE FOR MOST CURRENT INFORMATION.
2. WOOD NAILER MUST BE INSTALLED TO MEET APPLICABLE BUILDING CODES.
3. FLANGE OF METAL MUST BE FULLY SUPPORTED BY WOOD AND TERMINATED AT LEAST 1/2" (13 mm) FROM EDGE OF WOOD.
4. MINIMUM 3 1/2" (88.9 mm) WIDE SPLICE PLATE REQUIRED AT JOINTS.
5. STANDARD FASCIA WILL NOT FUNCTION WITH EZ TPO MEMBRANE STRIP IN MEMBRANE THICKER THAN 60 MIL.
6. OIL CANNING CAN OCCUR ON LARGER FACE HEIGHTS. MINIMUM OF 0.050" OR 0.063" MATERIAL RECOMMENDED FOR FACE HEIGHTS ABOVE 8" (203.2 mm).
7. WELDED ACCESSORIES REQUIRE A MINIMUM OF MATERIAL THICKNESS OF 0.050".
8. REFER TO DETAIL EZT-FB-LS-01 OR EZT-FB-LS-03 FOR WELD WIDTH.
9. WHEN REINFORCEMENT OF TPO MEMBRANE IS EXPOSED, REFER TO EZT-LS-14 FOR CUT EDGE SEALANT APPLICATION.
10. APPROPRIATE GENFLEX MEMBRANE ADHESIVE REQUIRED BETWEEN MEMBRANE AND INSULATION FOR ADHERED SYSTEMS. MEMBRANE ADHESIVE REQUIRED BETWEEN METAL DAM AND MEMBRANE FOR ALL SYSTEMS.

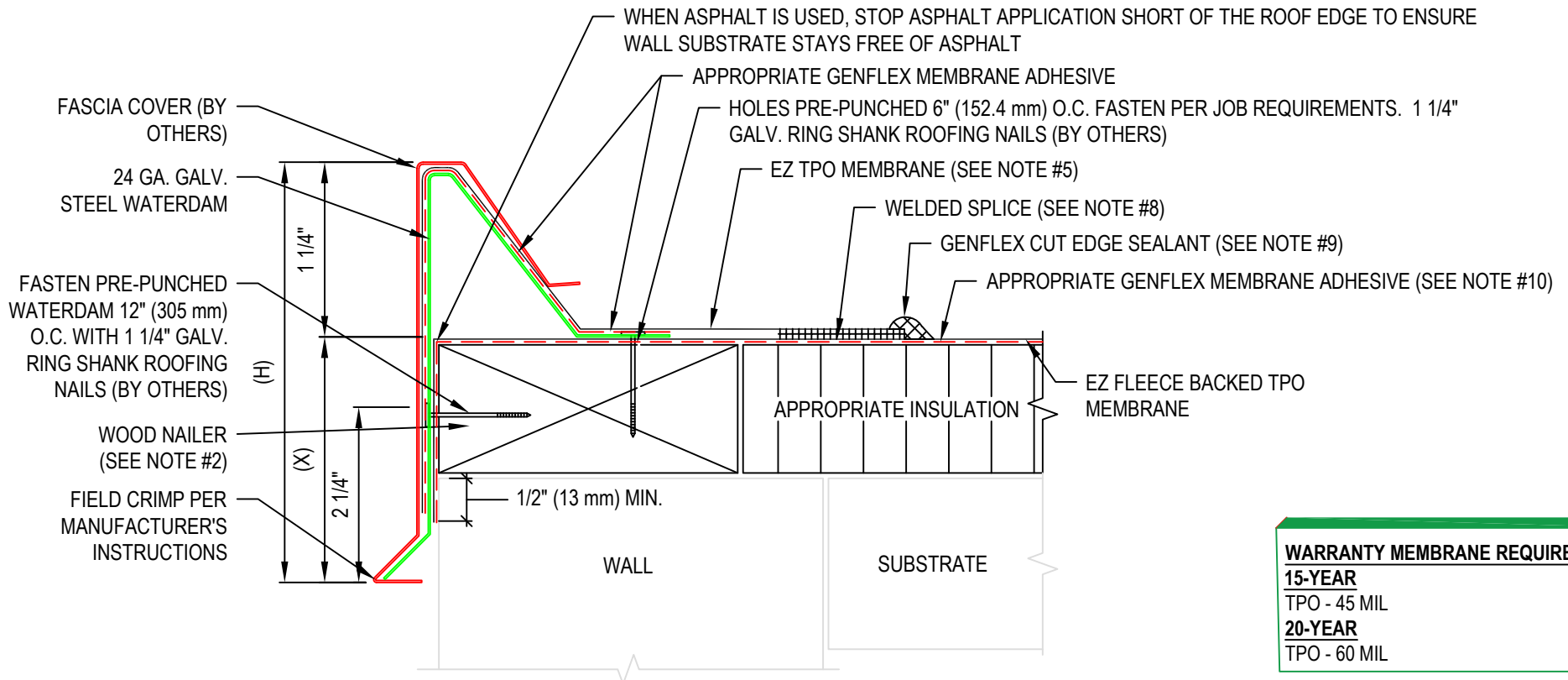

**WARRANTY MEMBRANE REQUIREMENTS:**  
**15-YEAR**  
 TPO - 45 MIL  
**20-YEAR**  
 TPO - 60 MIL



**EZ FLEECE BACKED TPO MEMBRANE ROOF EDGE  
 WITH CANTED METAL ROOF EDGE AND CRIMP-ON FASCIA**

MATERIAL: EZ FLEECE BACKED TPO      ACCEPTABLE SYSTEMS: ALL

MAXIMUM WARRANTY: 20 Years

ISSUE / REVISION DATE:  
 04/20/2026

DETAIL NO.  
**EZT-FB-RE-02**