

USE APPROPRIATE TERMINATION

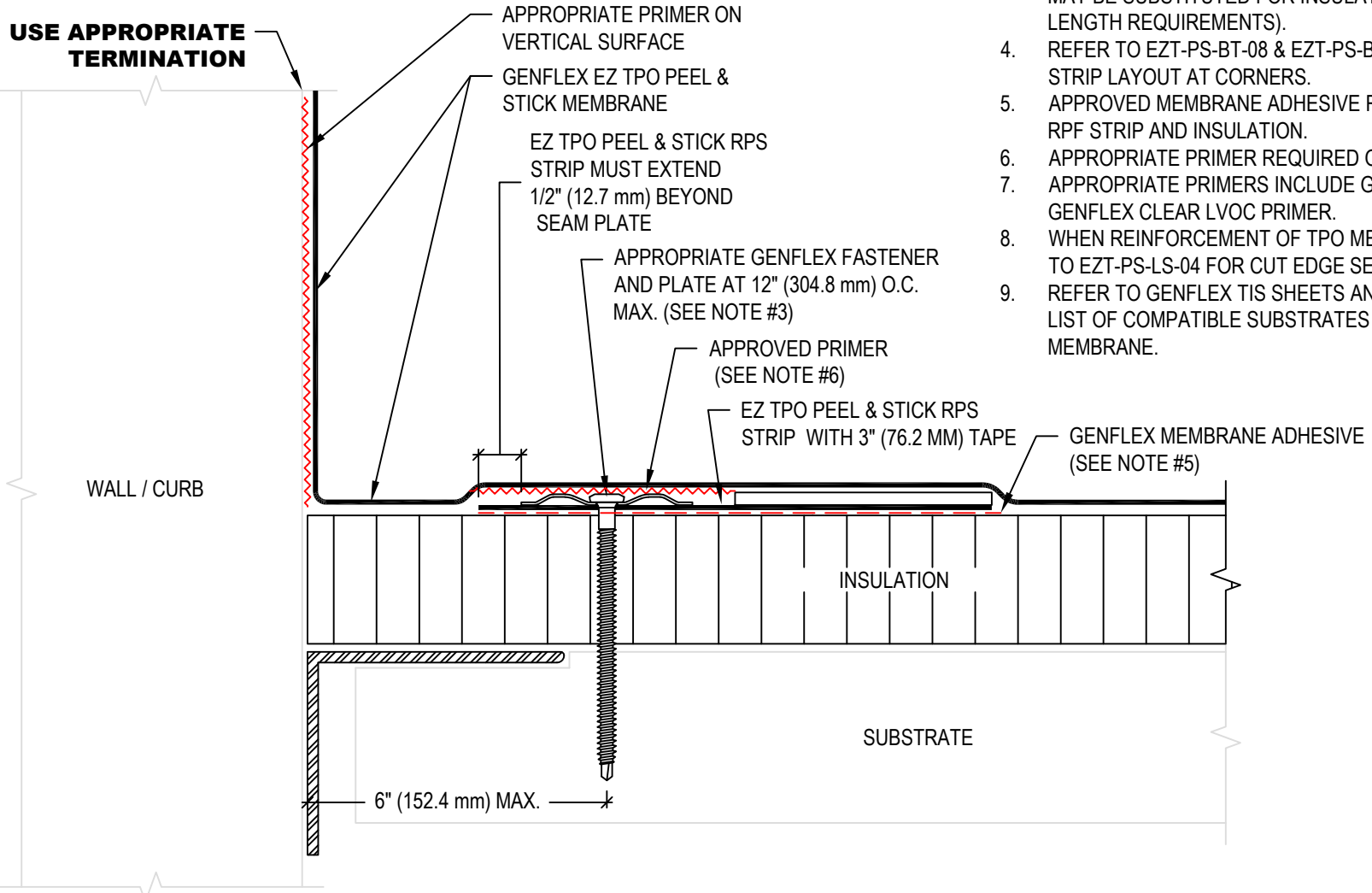

NOTE:

1. REFER TO THE GENFLEX™ WEBSITE FOR MOST CURRENT INFORMATION.
2. REFER TO DETAIL EZT-PS-LS-01 OR EZT-PS-LS-02 FOR WELD WIDTH.
3. MAXIMUM 10" (254 mm) LONG FASTENERS (NOTE: WOOD BLOCKING MAY BE SUBSTITUTED FOR INSULATION TO REDUCE FASTENER LENGTH REQUIREMENTS).
4. REFER TO EZT-PS-BT-08 & EZT-PS-BT-09 FOR QUICKSEAM RPS STRIP LAYOUT AT CORNERS.
5. APPROVED MEMBRANE ADHESIVE REQUIRED BETWEEN QUICKSEAM RPS STRIP AND INSULATION.
6. APPROPRIATE PRIMER REQUIRED ON ALL VERTICAL SURFACES.
7. APPROPRIATE PRIMERS INCLUDE GENFLEX CLEAR PRIMER AND GENFLEX CLEAR LVOC PRIMER.
8. WHEN REINFORCEMENT OF TPO MEMBRANE IS EXPOSED, REFER TO EZT-PS-LS-04 FOR CUT EDGE SEALANT APPLICATION
9. REFER TO GENFLEX TIS SHEETS AND APPLICATION GUIDES FOR LIST OF COMPATIBLE SUBSTRATES WITH EZ TPO PEEL & STICK MEMBRANE.



BASE TIE-IN WITH EZ TPO PEEL & STICK RPS STRIP AND GENFAST FASTENER AND PLATE - DECK OBSTRUCTION

MATERIAL: EZ TPO P&S

ACCEPTABLE SYSTEMS: ADHERED

GENFLEX: (800) 443-4272 www.genflex.com

MAXIMUM WARRANTY: 20 Years

ISSUE / REVISION DATE:
04/20/2026

DETAIL NO.
EZT-PS-BT-06

NOT TO SCALE