

GENFLEX REQUIRES 4-1/2" (114.3 mm) TPO T-JOINT COVER OR TPO NON-REFINFORCED FLASHING (4" (101.6 mm) x 4" (101.6mm) MIN.) CENTERED OVER INTERSECTION OF SEAM.

PLAN VIEW

PIPE FLASHING OVER SEAM

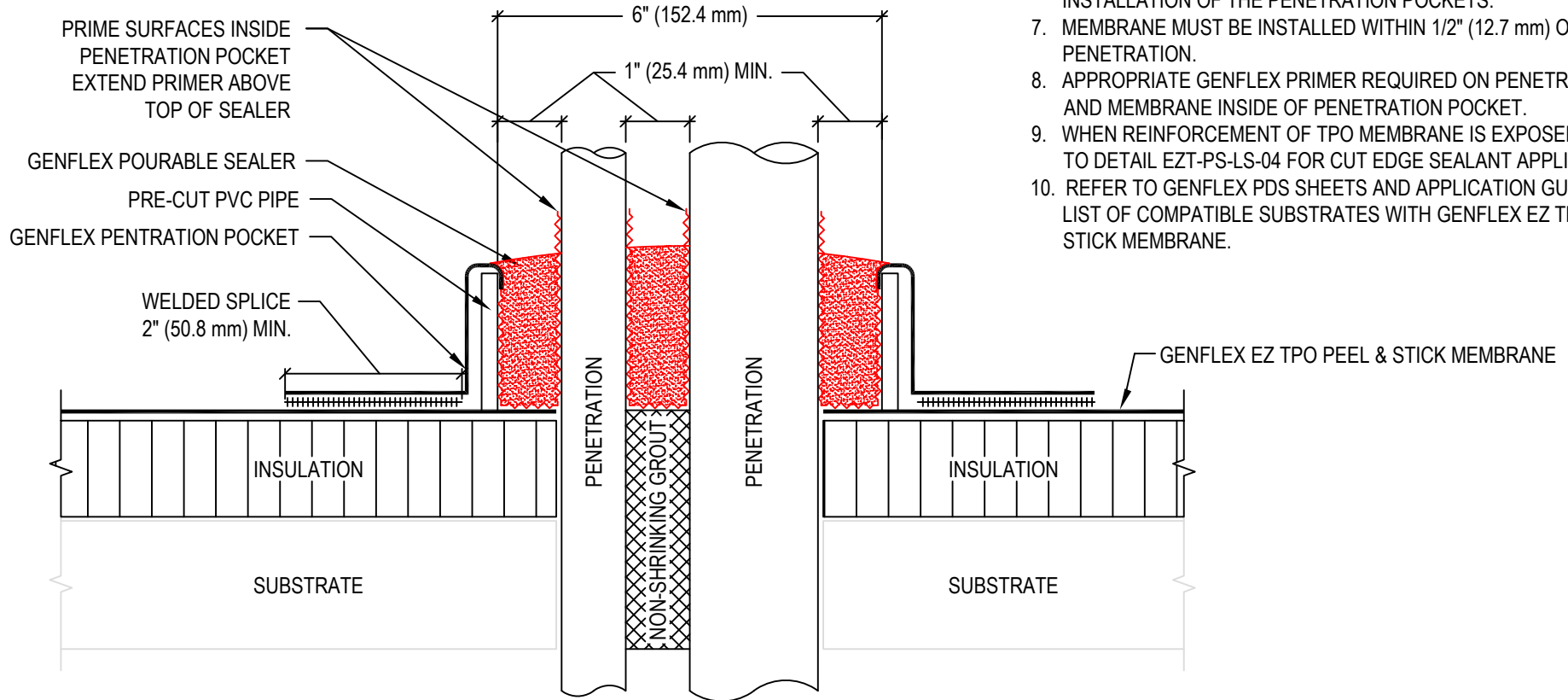

NOTE:

1. REFER TO THE GENFLEX™ WEBSITE FOR THE MOST CURRENT INFORMATION.
2. REMOVE ALL EXISTING FLASHING, LEAD, ETC. PIPE SURFACE MUST BE FREE OF ALL RUST, GREASE, INSULATION, ETC.
3. GENFLEX POURABLE SEALER MOUNTED TO SHED WATER: MIN. DEPTH OF 2" (50.8 mm), REMAINDER OF POCKET MAY BE FILLED WITH A NON-SHRINKING GROUT.
4. DO NOT USE OVER EXISTING PENETRATION POCKETS.
5. DO NOT USE WHEN SERVICE LINE TEMP. EXCEEDS 160 °F (71 °C).
6. IF FIELD MEMBRANE IS CUT FOR INSULATION, THE MEMBRANE MUST BE REPAIRED WITH GENFLEX TPO MEMBRANE PRIOR TO INSTALLATION OF THE PENETRATION POCKETS.
7. MEMBRANE MUST BE INSTALLED WITHIN 1/2" (12.7 mm) OF PENETRATION.
8. APPROPRIATE GENFLEX PRIMER REQUIRED ON PENETRATIONS AND MEMBRANE INSIDE OF PENETRATION POCKET.
9. WHEN REINFORCEMENT OF TPO MEMBRANE IS EXPOSED, REFER TO DETAIL EZT-PS-LS-04 FOR CUT EDGE SEALANT APPLICATION.
10. REFER TO GENFLEX PDS SHEETS AND APPLICATION GUIDES FOR LIST OF COMPATIBLE SUBSTRATES WITH GENFLEX EZ TPO PEEL & STICK MEMBRANE.



PENETRATION WITH A PENETRATION POCKET

MAXIMUM WARRANTY: 20 Years

ISSUE / REVISION DATE:

04/20/2026

DETAIL NO.

EZT-PS-P-04

MATERIAL: EZ TPO P&S

ACCEPTABLE SYSTEMS: ADHERED

NOT TO SCALE

GENFLEX: (800) 443-4272 www.genflex.com