

NOTE:

1. REFER TO THE GENFLEX™ WEBSITE FOR MOST CURRENT INFORMATION.
2. METAL COPING TO BE FABRICATED AND INSTALLED IN ACCORDANCE WITH CURRENT SMACNA RECOMMENDATIONS. WATERTIGHT INTEGRITY OF WALL AND METAL COPING SHALL BE ENSURED BY OTHERS.
3. WOOD NAILER MUST BE INSTALLED TO MEET APPLICABLE BUILDING CODES.
5. GENFLEX EZ TPO PEEL & STICK CAN BE USED AS VERTICAL WALL FLASHING.
6. APPROPRIATE PRIMER REQUIRED ON ALL VERTICAL SURFACES WHEN EZ TPO PEEL & STICK MEMBRANE IS USED FOR FLASHING.
7. REFER TO TPO APPLICATION GUIDE FOR ACCEPTABLE FLASHING SUBSTRATES.
8. IF INTERMEDIATE ATTACHMENT IS REQUIRED, COMPLETE AS FOLLOWS:
 - UP TO 5' (1.52 m) WALL HEIGHT - NONE REQUIRED
 - 5' (1.52 m) - 10' (3.05 m) WALL HEIGHT - ONE ATTACHMENT AT 1/2 THE WALL HEIGHT
 - ABOVE 10' (3.05 m) - ONE ATTACHMENT EVERY 3' (0.91 m)

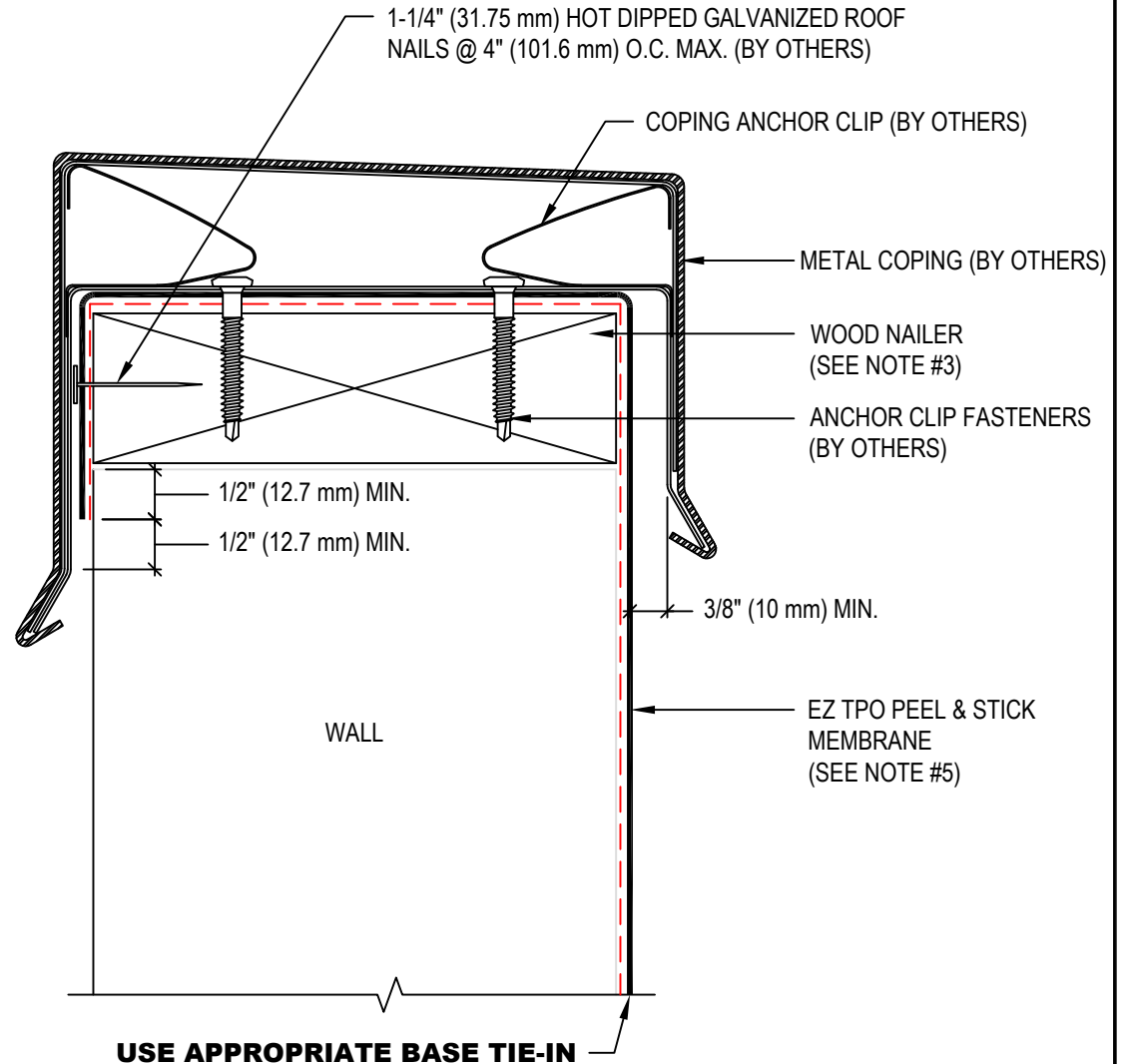

| | | | | |
|--|---|-----------------------------|--------------------------------------|----------------------------------|
|  | TERMINATION AT TOP OF WALL WITH METAL COPING | | MAXIMUM WARRANTY: 20 Years | |
| | MATERIAL: EZ TPO P&S | ACCEPTABLE SYSTEMS: ADHERED | ISSUE / REVISION DATE: 04/20/2026 | DETAIL NO. EZT-PS-T-03 |
| GENFLEX: (800) 443-4272 www.genflex.com | | | NOT TO SCALE | |