

**USE APPROPRIATE TERMINATION**

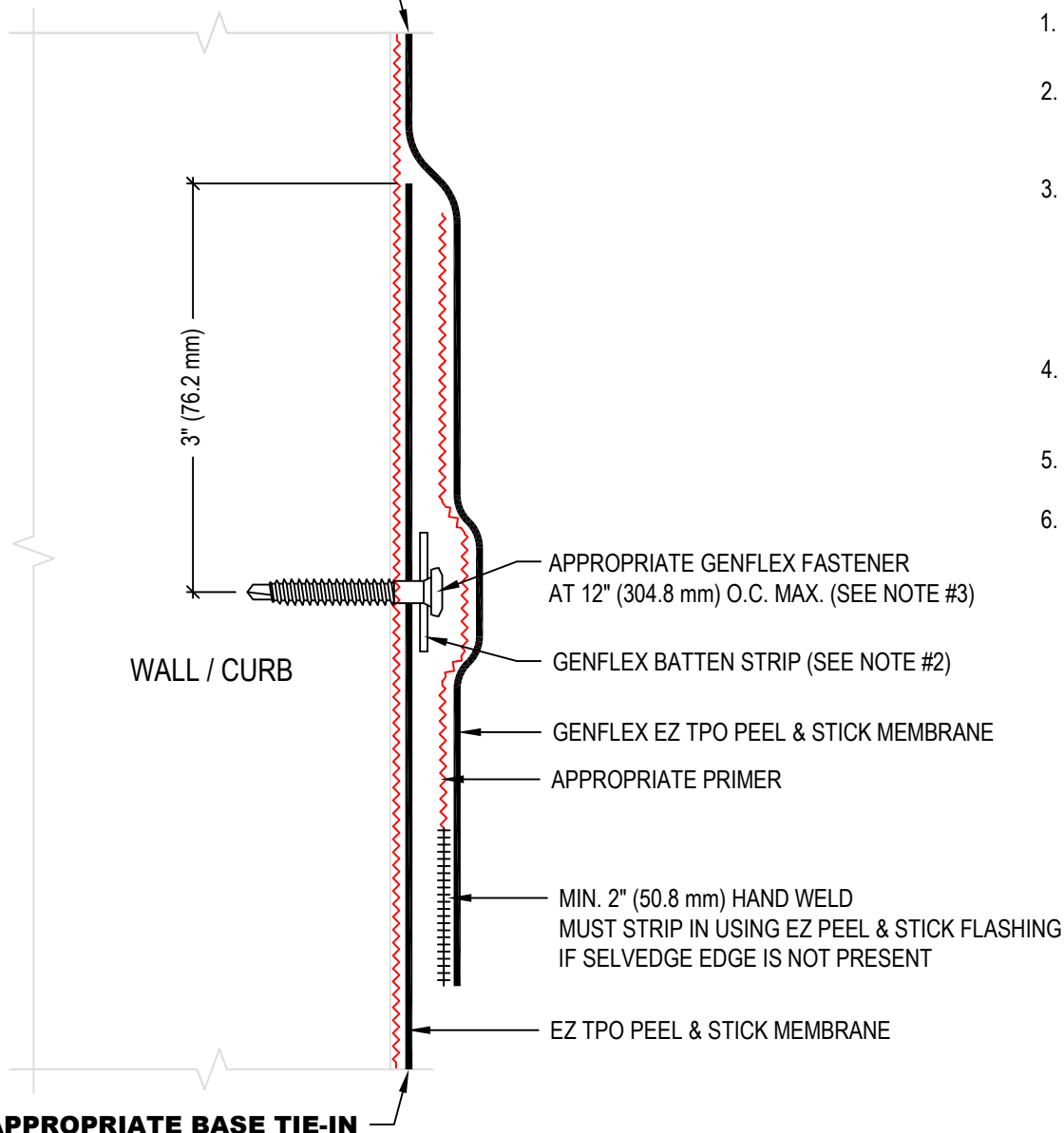

NOTE:

1. REFER TO THE GENFLEX™ WEBSITE FOR MOST CURRENT INFORMATION.
2. METAL BATTEN STRIP ACCEPTABLE FOR WOOD OR METAL SUBSTRATE. METAL BATTEN MUST BE USED WITH MASONRY SUBSTRATE.
3. IF INTERMEDIATE ATTACHMENT IS REQUIRED, COMPLETE AS FOLLOWS:
  - UP TO 5' (1.52 m) WALL HEIGHT- NONE REQUIRED
  - 5' (1.52 m) - 10' (3.05 m) WALL HEIGHT - ONE ATTACHMENT AT 1/2 THE WALL HEIGHT
  - ABOVE 10' (3.05 m) - ONE ATTACHMENT EVERY 3' (1 m)
4. WHEN REINFORCEMENT OF TPO MEMBRANE IS EXPOSED, REFER TO EZT-PS-LS-07 FOR CUT EDGE SEALANT APPLICATION.
5. REFER TO TPO APPLICATION GUIDE FOR ACCEPTABLE FLASHING SUBSTRATES.
6. APPROPRIATE PRIMER REQUIRED ON ALL VERTICAL SURFACES.

**USE APPROPRIATE BASE TIE-IN**



**INTERMEDIATE WALL FLASHING ATTACHMENT WITH GENFLEX  
EZ TPO PEEL & STICK MEMBRANE AND BATTEN STRIP**

MATERIAL: EZ TPO P&S

ACCEPTABLE SYSTEMS: ADHERED

MAXIMUM WARRANTY: 20 Years

ISSUE / REVISION  
DATE:

04/20/2026

DETAIL NO.

**EZT-PS-T-15**

NOT TO SCALE

GENFLEX: (800) 443-4272 www.genflex.com