

USE APPROPRIATE TERMINATION

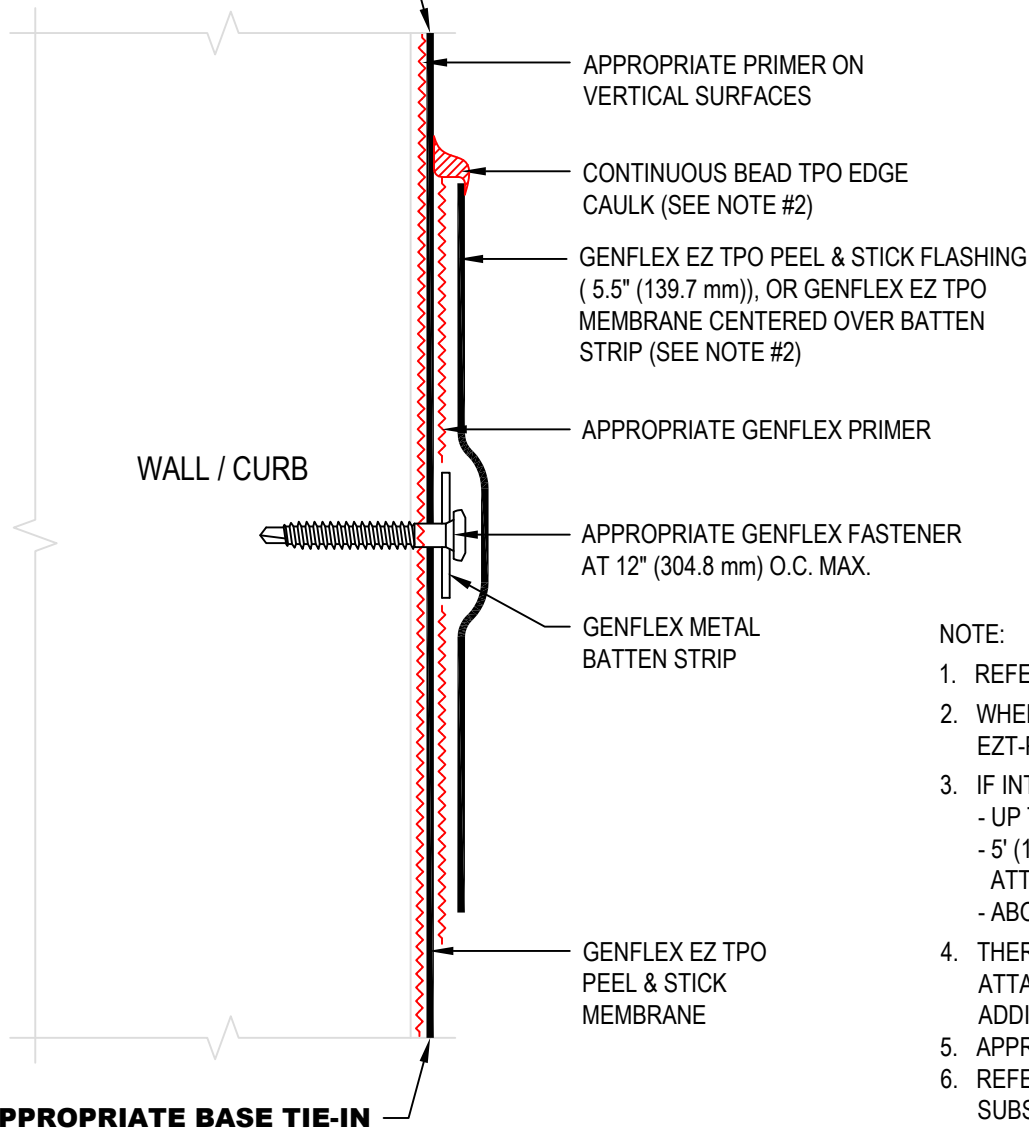

NOTE:

1. REFER TO THE GENFLEX™ WEBSITE FOR MOST CURRENT INFORMATION.
2. WHEN REINFORCEMENT OF TPO MEMBRANE IS EXPOSED, REFER TO EZT-PS-LS-07 FOR CUT EDGE SEALANT APPLICATION.
3. IF INTERMEDIATE ATTACHMENT IS REQUIRED, COMPLETE AS FOLLOWS:
 - UP TO 5' (1.52 m) WALL HEIGHT - NONE REQUIRED
 - 5' (1.5 m) - 10' (3.05 m) WALL HEIGHT - ONE ATTACHMENT AT 1/2 THE WALL HEIGHT
 - ABOVE 10' (3.05 m) - ONE ATTACHMENT EVERY 3' (1 m)
4. THERE ARE SOME CONDITIONS WHICH DO NOT REQUIRE INTERMEDIATE ATTACHMENT. REFER TO GENFLEX APPLICATION SPECIFICATIONS FOR ADDITIONAL INFORMATION.
5. APPROPRIATE PRIMER REQUIRED ON ALL VERTICAL SURFACES.
6. REFER TO EZ TPO APPLICATION GUIDE FOR ACCEPTABLE FLASHING SUBSTRATES.

USE APPROPRIATE BASE TIE-IN



INTERMEDIATE WALL FLASHING ATTACHMENT WITH GENFLEX EZ TPO PEEL & STICK FLASHING

MATERIAL: EZ TPO P&S

ACCEPTABLE SYSTEMS: ADHERED

GENFLEX: (800) 443-4272 www.genflex.com

MAXIMUM WARRANTY: 20 Years

ISSUE / REVISION DATE:

04/20/2026

NOT TO SCALE

DETAIL NO.

EZT-PS-T-16