

NOTE:

1. REFER TO GENFLEX™ WEBSITE FOR MOST CURRENT INFORMATION.
2. WOOD NAILER MUST BE INSTALLED TO MEET APPLICABLE BUILDING CODES.
3. GENFLEX MEMBRANE ADHESIVE REQUIRED BETWEEN MEMBRANE AND INSULATION FOR ADHERED SYSTEMS.
4. HEAVYWEIGHT ROOF PAVER - MIN 10 LB (4.5 kg) PER SQ. FT. INSTALLED OVER PROTECTION LAYER REQUIRED FOR BALLASTED SYSTEMS.
5. WHEN CHANGE IN ELEVATION OCCURS BETWEEN SYSTEMS, USE APPROPRIATE TAPERED INSULATION TO CREATE A SMOOTH TRANSITION.

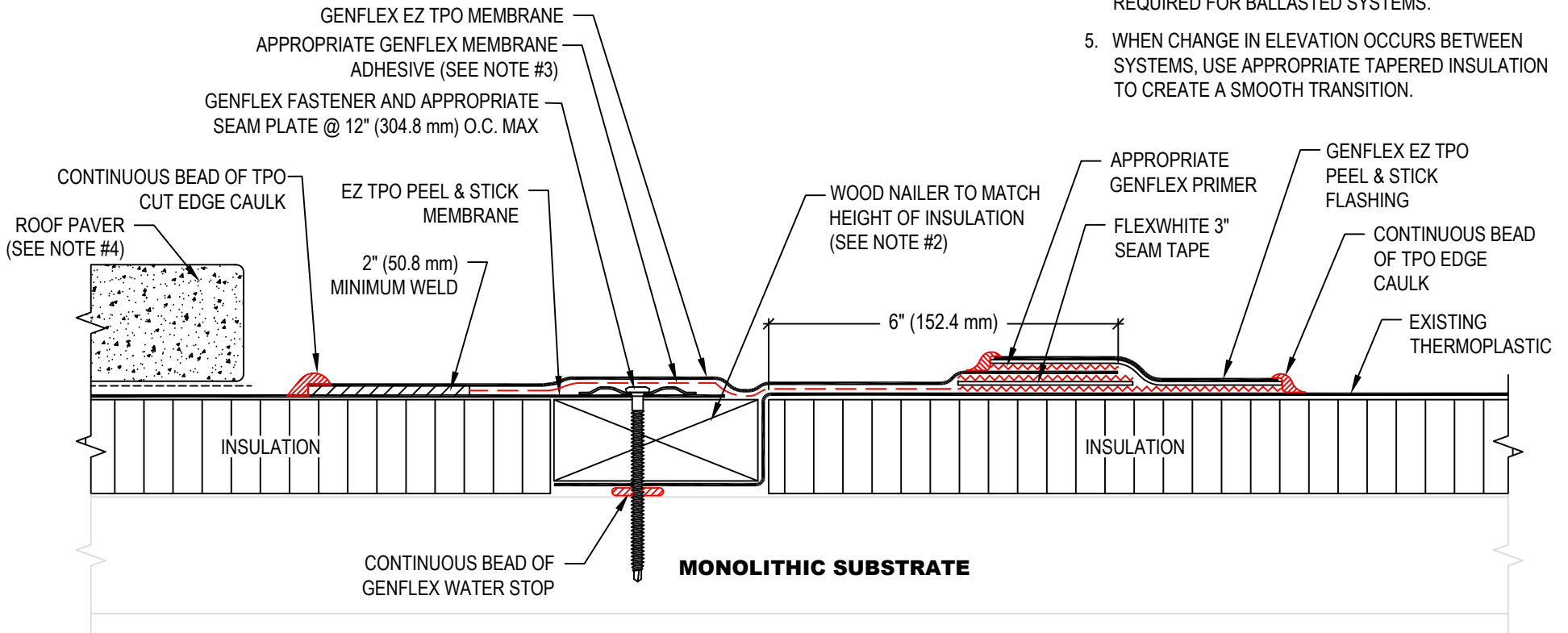

TIE-IN TO EXISTING ROOF SYSTEMS NOT WARRANTED BY GENFLEX

	TIE-IN USING GENFLEX EZ TPO PEEL & STICK SYSTEM TO EXISTING THERMOPLASTIC SYSTEM (MONOLITHIC SUBSTRATE)		MAXIMUM WARRANTY: 20 Years	
	MATERIAL: EZ TPO P&S	ACCEPTABLE SYSTEMS: ADHERED	ISSUE / REVISION DATE: 04/20/2026	DETAIL NO. EZT-PS-T-17
	GENFLEX: (800) 443-4272 www.genflex.com		NOT TO SCALE	