

METAL EXTENDED SNAP-ON FASCIA DIMENSIONS

(H)	(X)
8 1/2" (215.9 mm)	7 1/4" (184.15 mm)
10" (254 mm)	8 3/4" (222.25 mm)
11 1/2" (292.1 mm)	10 1/4" (260.35 mm)
1'-1" (330.2 mm)	11 1/4" (285.75 mm)

NOTE:

1. REFER TO THE GENFLEX™ WEBSITE FOR MOST CURRENT INFORMATION.
2. REFER TO MANUFACTURER'S INFORMATION FOR FASCIA SIZES, ACCESSORIES, AND FINISHES AVAILABLE.
3. WOOD NAILER MUST BE INSTALLED TO MEET APPLICABLE BUILDING CODES.
4. MINIMUM 3 1/2" (88.9 mm) SPLICE PLATES REQUIRED AT ALL JOINTS

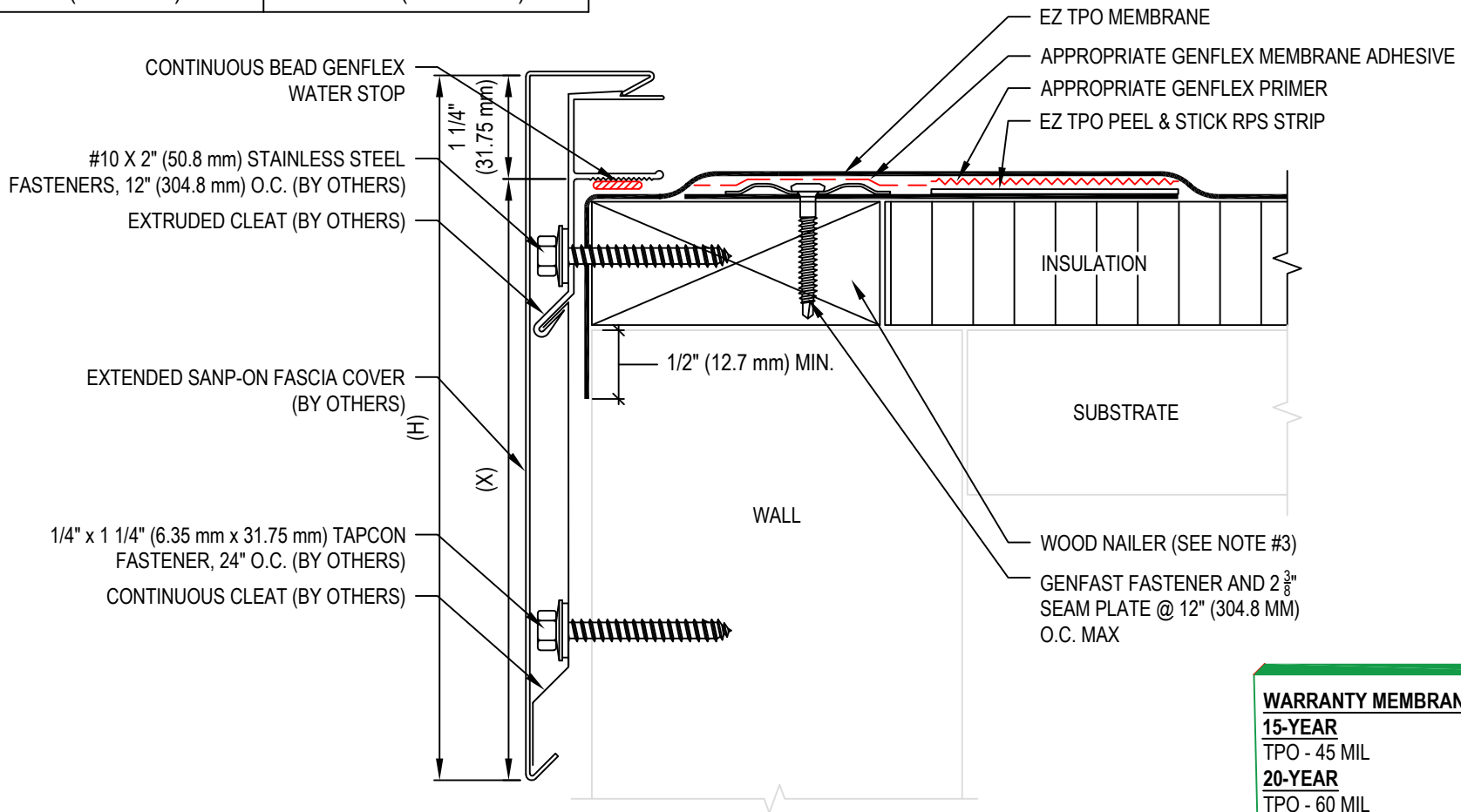

WARRANTY MEMBRANE REQUIREMENTS:

15-YEAR
TPO - 45 MIL
20-YEAR
TPO - 60 MIL



EZ TPO ROOF EDGE WITH EXTENDED SNAP-ON FASCIA AND EXTRUDED CLEAT - PEEL & STICK RPS

MATERIAL: EZ TPO

ACCEPTABLE SYSTEMS: ALL

MAXIMUM WARRANTY: 20 Years

ISSUE / REVISION DATE:

04/20/2026

DETAIL NO.

EZT-RE-06

NOT TO SCALE

GENFLEX: (800) 443-4272 www.genflex.com