

SNAP-ON CANTED EDGE

(H)	(X)	NAILER COVERAGE
5 1/4"	2 7/8"	1
6 3/4"	4 3/8"	2
8 1/4"	5 7/8"	3
9 3/4"	7 3/8"	4
11 1/4"	8 7/8"	5
1'-0 3/4"	10 3/8"	6

NOTE:

1. REFER TO THE GENFLEX™ WEBSITE FOR MOST CURRENT INFORMATION.
2. WOOD NAILER MUST BE INSTALLED TO MEET APPLICABLE BUILDING CODES.
3. FLANGE OF METAL MUST BE FULLY SUPPORTED BY WOOD AND TERMINATED AT LEAST 1/2" (12.7 mm) FROM EDGE OF WOOD.
4. MINIMUM 3 1/2" (88.9 mm) WIDE SPLICE PLATE REQUIRED AT JOINTS.
5. STANDARD FASCIA WILL NOT FUNCTION WITH TPO STRIP IN MEMBRANE THICKER THAN 60 MIL. SEE DETAIL EZT-RE-12.
6. OIL CANNING CAN OCCUR ON LARGER FACE HEIGHTS, MINIMUM 0.050" OR 0.063" THICK MATERIALS RECOMMENDED FOR FACE HEIGHTS ABOVE 8 1/4" (209.6 mm).
7. WELDED ACCESSORIES REQUIRE A MINIMUM OF MATERIAL THICKNESS OF 0.050".
8. REFER TO DETAIL EZT-LS-01 OR EZT-LS-02 FOR WELD WIDTH.
9. WHEN REINFORCEMENT OF TPO MEMBRANE IS EXPOSED, REFER TO EZT-LS-14 FOR CUT EDGE SEALANT APPLICATION.
10. APPROPRIATE GENFLEX MEMBRANE ADHESIVE REQUIRED BETWEEN MEMBRANE AND INSULATION FOR ADHERED SYSTEMS. MEMBRANE ADHESIVE REQUIRED BETWEEN METAL DAM AND MEMBRANE FOR ALL SYSTEMS.

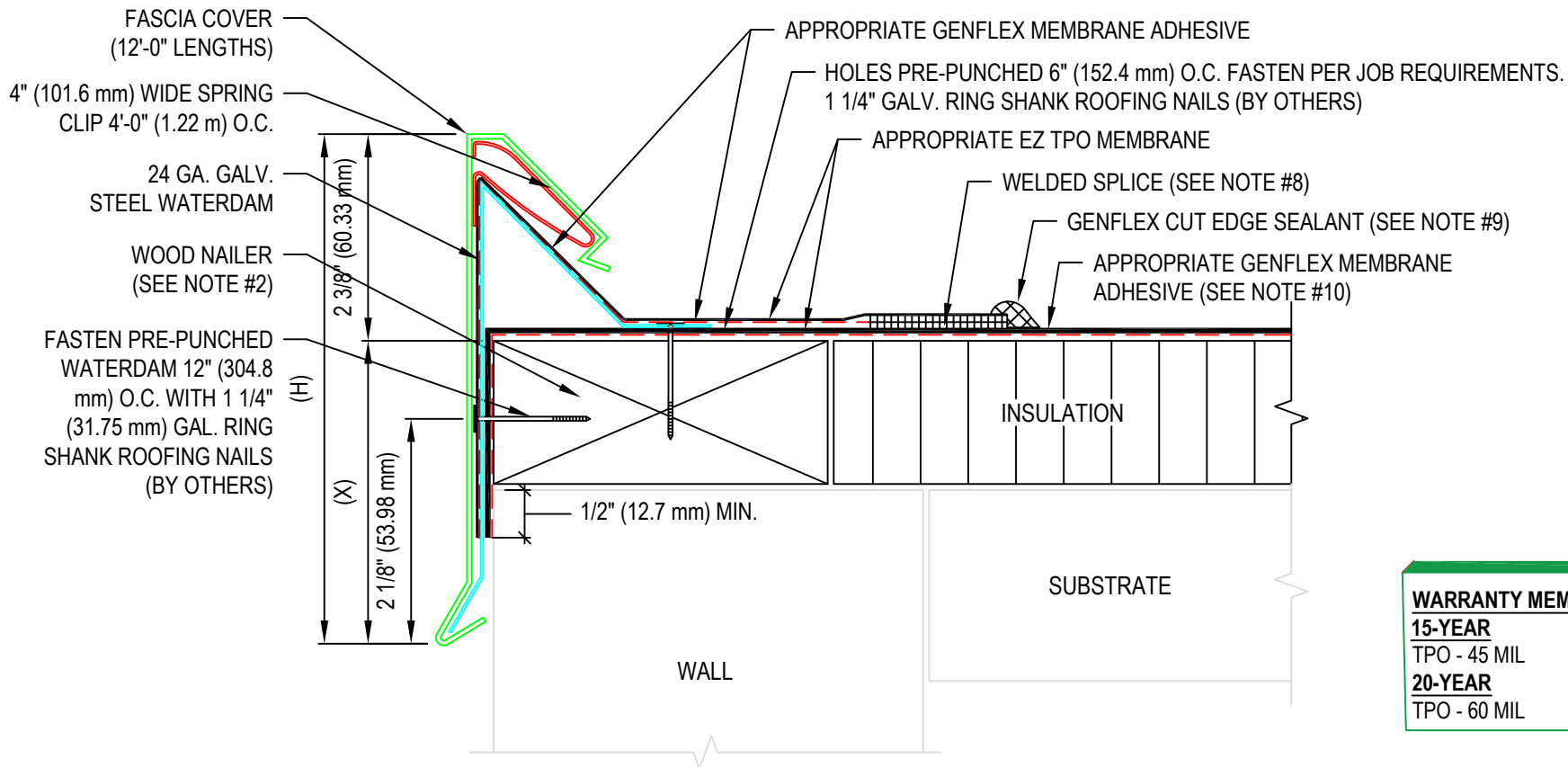

WARRANTY MEMBRANE REQUIREMENTS:

15-YEAR

TPO - 45 MIL

20-YEAR

TPO - 60 MIL



CANTED METAL ROOF EDGE - SNAP ON VERSION WITH SEPARATE FLASHING

MATERIAL: EZ TPO

ACCEPTABLE SYSTEMS: ALL

MAXIMUM WARRANTY: 20 Years

ISSUE / REVISION DATE:

04/20/2026

DETAIL NO.

EZT-RE-12

NOT TO SCALE

GENFLEX: (800) 443-4272 www.genflex.com