

NOTE:

1. REFER TO THE GENFLEX™ WEBSITE FOR MOST CURRENT INFORMATION.
2. ALLOW 1/4" (6.35 mm) MAX. SPACE BETWEEN SECTIONS OF DRAIN BAR.
3. ROUND ALL METAL CORNERS AND PLACE BREAK OF GUTTER STRAP 1/4" (6.35 mm) BELOW TOP OF WOOD NAILER.
4. DO NOT PRE-NAIL MEMBRANE TO FACE OF THE WOOD NAILER.
5. CONSTRUCT AND ANCHOR GUTTER IN ACCORDANCE WITH SMACNA.
6. WOOD NAILER MUST BE INSTALLED TO MEET APPLICABLE BUILDING CODES.
7. ON BALLASTED ROOFS, DRAIN BAR HEIGHT MUST MEET OR EXCEED BALLAST OR PAVER HEIGHT (2" (50.8 mm) MIN. ABOVE ROOF SURFACE).
8. GENFAST TERMINATION BAR AND STAINLESS FASTENERS MAY BE USED IN LIEU OF METAL DRAIN BAR FOR MECHANICALLY ATTACHED AND ADHERED SYSTEMS.

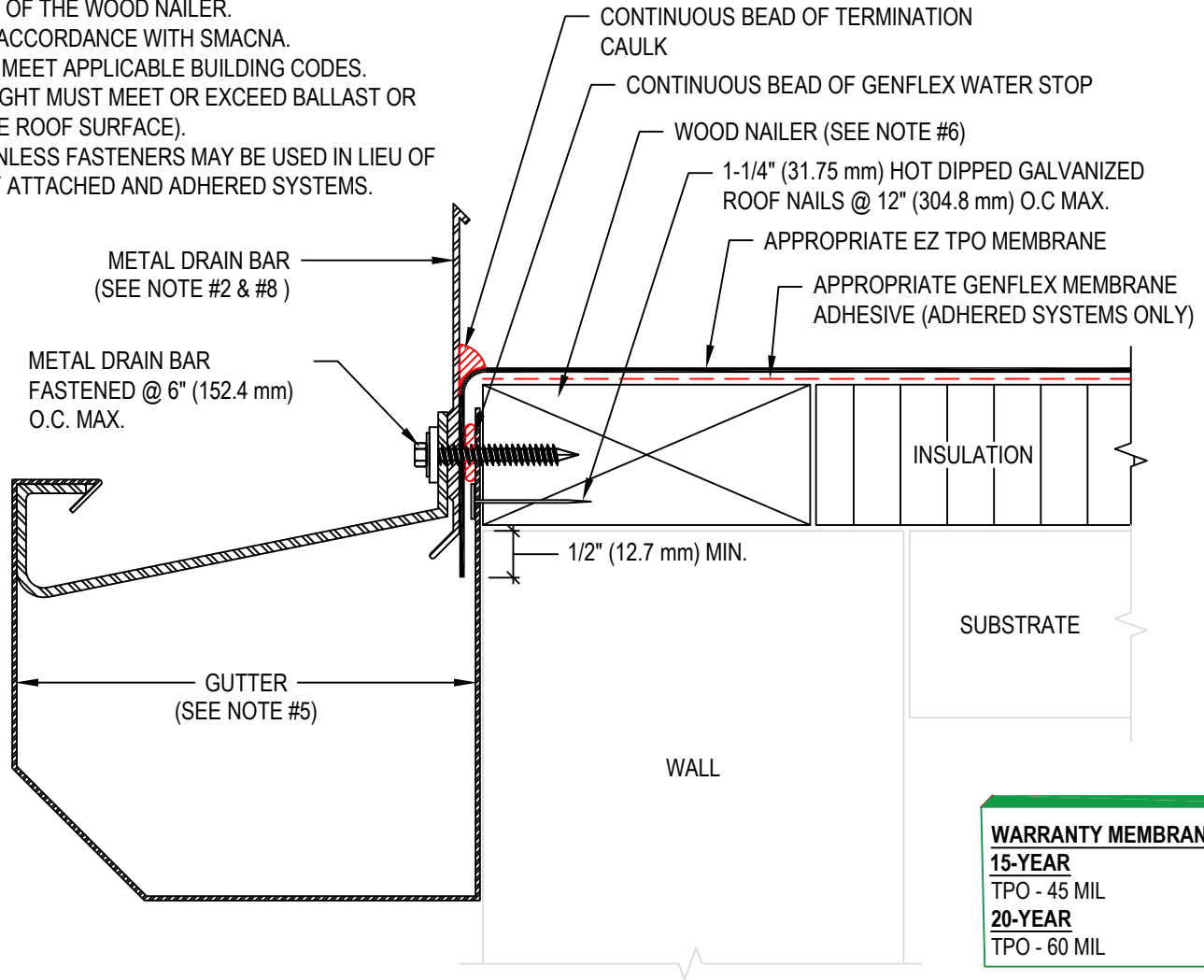

WARRANTY MEMBRANE REQUIREMENTS:
15-YEAR
 TPO - 45 MIL
20-YEAR
 TPO - 60 MIL



EZ TPO ROOF EDGE - GUTTER WITH METAL DRAIN BAR

MATERIAL: EZ TPO

ACCEPTABLE SYSTEMS: ALL

MAXIMUM WARRANTY: 20 Years

ISSUE / REVISION DATE:

04/20/2026

DETAIL NO.

EZT-RE-13

NOT TO SCALE