

WARRANTY MEMBRANE REQUIREMENTS:

15-YEAR

TPO - 45 MIL

20-YEAR

TPO - 60 MIL

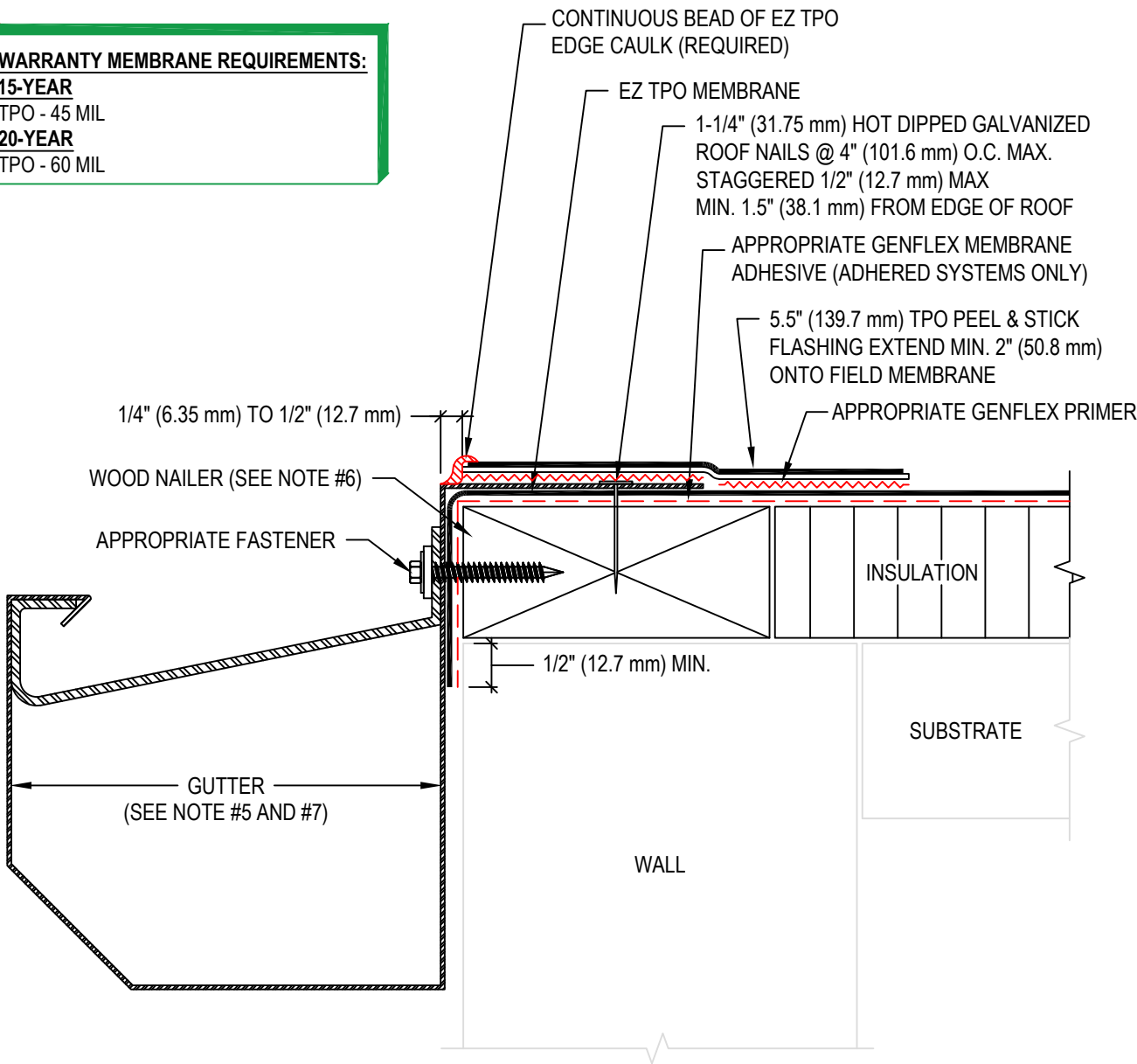

NOTE:

1. REFER TO THE GENFLEX™ WEBSITE FOR THE MOST CURRENT INFORMATION.
2. EDGE CAULK IS REQUIRED ALONG ENTIRE UPSLOPE EDGE OF PEEL & STICK FLASHING WHEN ROOF SLOPE IS 1" (25.4 mm) PER FOOT OR GREATER.
3. ROUND ALL METAL CORNERS AND PLACE BACK OF GUTTER STRAP 1/4" (6.35 mm) BELOW TOP OF WOOD NAILER.
4. DO NOT PRE-NAIL MEMBRANE TO THE FACE OF THE WOOD NAILER.
5. CONSTRUCT AND ANCHOR GUTTER IN ACCORDANCE WITH SMACNA RECOMMENDATIONS.
6. WOOD NAILER MUST BE INSTALLED TO MEET APPLICABLE BUILDING CODES.
7. FLANGE OF METAL GUTTER MUST BE FULLY SUPPORTED BY WOOD AND TERMINATED AT LEAST 1/2" (12.7 mm) FROM EDGE WOOD.
8. CONTACT GENFLEX ROOFING SOLUTION FOR BALLASTED ROOF SYSTEMS.
9. IF THE THE FLANGE OF THE METAL GUTTER IS NOT COMPLETELY COVERED WITH PEEL & STICK FLASHING, THEN AN ADDITIONAL PIECE OF PEEL & STICK FLASHING SHALL BE INSTALLED AT ALL METAL SPLICES. REFER TO EZT-RE-27.
10. TO ENSURE FORMABILITY, SLIGHTLY HEAT-FORM THE SURFACE OF TPO PEEL & STICK PRODUCTS AT STEP-OFFS AND ANGLE CHANGES.



EZ TPO ROOF EDGE AT GUTTER WITH FLANGE AND TPO P&S FLASHING

MATERIAL: EZ TPO

ACCEPTABLE SYSTEMS: ALL

MAXIMUM WARRANTY: 20 Years

ISSUE / REVISION DATE:

04/20/2026

DETAIL NO.

EZT-RE-15

NOT TO SCALE

GENFLEX: (800) 443-4272 www.genflex.com