

NOTE:

1. REFER TO THE GENFLEX™ WEBSITE FOR THE MOST CURRENT INFORMATION.
2. REFER TO DETAIL EZT-LS-01 OR EZT-LS-02 FOR WELD WIDTH.
3. REFER TO DETAIL EZT-RE-23 FOR EZ TPO COATED METAL ROOF EDGE SPLICE.
4. INSTALL METAL WORK TO SMACNA RECOMMENDATIONS.
5. WOOD NAILER MUST BE INSTALLED TO MEET APPLICABLE BUILDING CODES.
6. FLANGE OF METAL MUST BE FULLY SUPPORTED BY WOOD AND TERMINATED AT LEAST 1/2" (12.7 mm) FROM EDGE OF WOOD.
7. ON BALLASTED ROOFS, GRAVEL STOP HEIGHT MUST MEET OR EXCEED BALLAST OR PAVER HEIGHT (2" (50.8 mm) MIN. ABOVE ROOF SURFACE).
8. WHEN REINFORCEMENT OF TPO MEMBRANE IS EXPOSED, REFER TO EZT-LS-14 FOR CUT EDGE SEALANT APPLICATION.

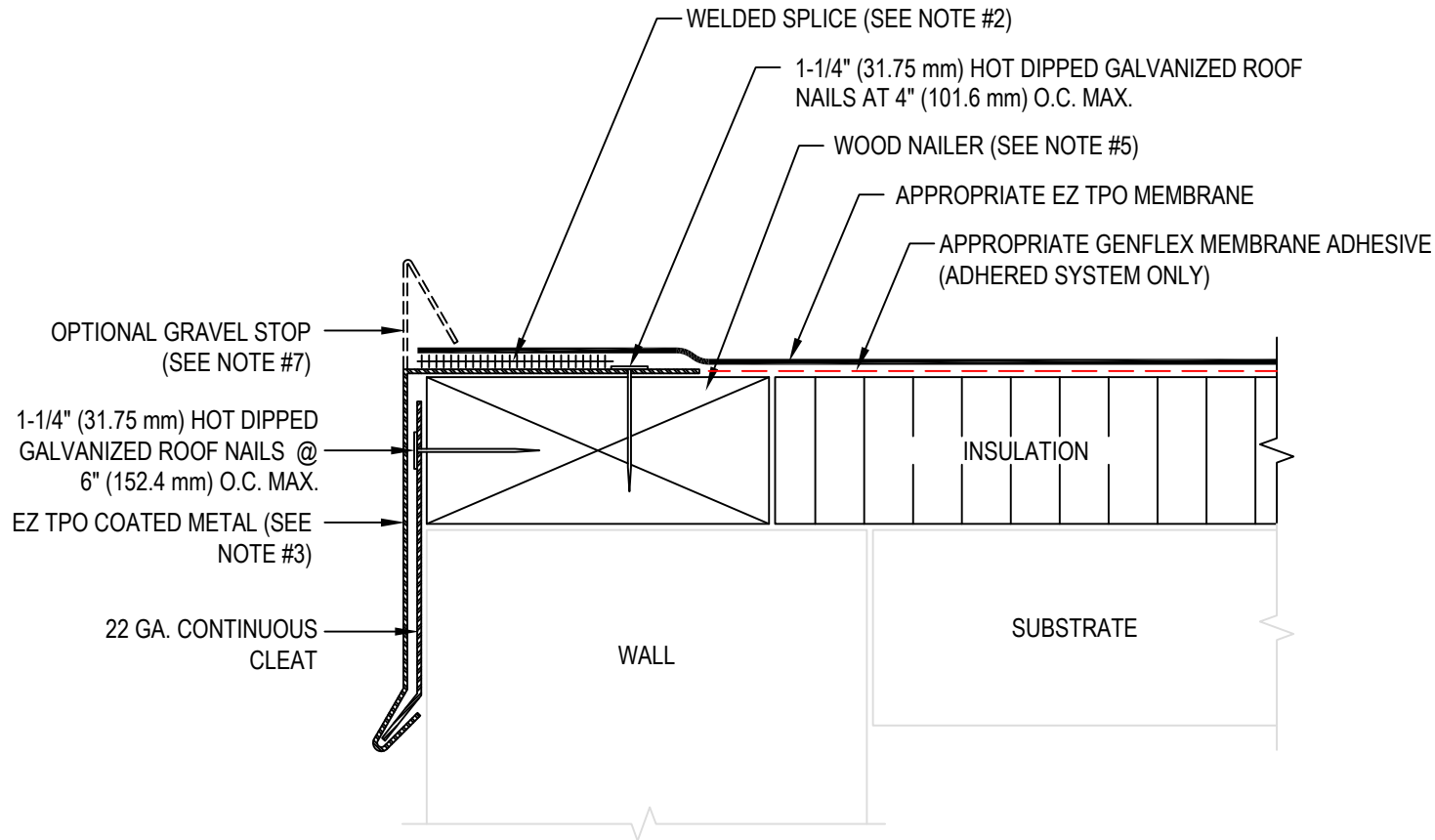

WARRANTY MEMBRANE REQUIREMENTS:
15-YEAR
 TPO - 45 MIL
20-YEAR
 TPO - 60 MIL



ROOF EDGE WITH EZ TPO COATED METAL

MATERIAL: EZ TPO

ACCEPTABLE SYSTEMS: ALL

MAXIMUM WARRANTY: 20 Years

ISSUE / REVISION DATE:

04/20/2026

DETAIL NO.

EZT-RE-22

GENFLEX: (800) 443-4272 www.genflex.com

NOT TO SCALE